

ABR71L9-RSE2

Barcode Reader — Scanner

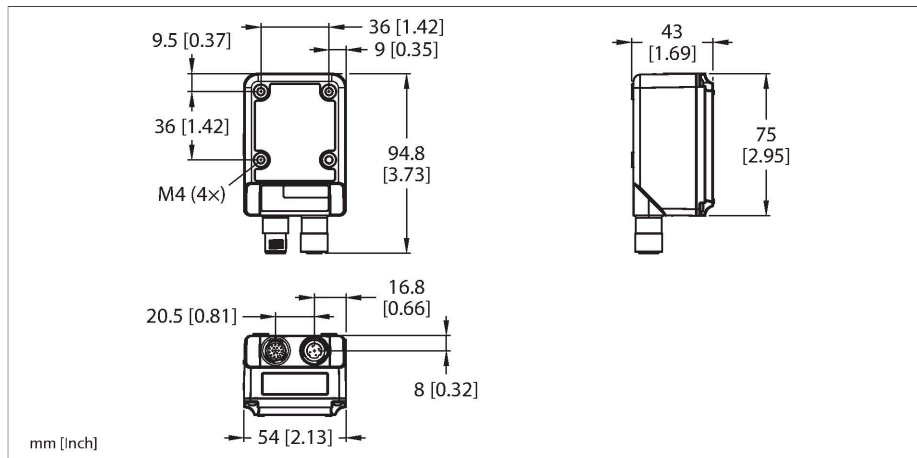

Features

- Camera-based barcode reader, 1D/2D codes
- 1.3-MP resolution, 1280 × 1024
- 9-mm lens, autofocus
- Integrated lighting, red
- Operating voltage 10...30 VDC
- Three PNP/NPN switching outputs, selectable via software
- Industrial Ethernet: PROFINET, EtherNet/IP, Modbus/TCP
- Serial interface, RS232/RS422
- Compact aluminum housing
- Protection class IP67

Functional principle

Camera-based barcode readers reliably capture 1D and 2D barcodes in any orientation. The ABR product series offers code-reading solutions that reliably decode hard-to-read codes, damaged codes and low-quality codes, as well as codes printed on highly reflective surfaces. The compact design with IP67 protection class offers reliable use in industrial environments. With resolutions of up to 2 MP, multiple lighting configurations, lens focal distances and autofocus, the ABR product series can handle even the most demanding track-and-trace applications. The barcode readers can be quickly configured via the Barcode Manager software, as well as with the integrated Quick Teach button. The configuration options via Industrial Ethernet and serial interfaces simplify device integration and enable IIoT data recording.

Technical data

Type	ABR71L9-RSE2
ID	3804448
Camera data	
Function	Barcode reader - scanner
Image sensor	CMOS
Resolution	1280 × 1024 pixels
Frame rate	60 fps
Light type	Red
Brennweite	9 mm
Electrical data	
Operating voltage U_B	10...30 VDC
Output function	PNP/NPN
Power on display	LED, Blue
Switching state	LED, Green
Error indication	LED, red
Mechanical data	
Design	Rectangular, ABR
Dimensions	54 x 43 x 75 mm
Housing material	Aluminium
Electrical connection	17-wire
Ambient temperature	0...+50 °C
Protection class	IP67
Tests/approvals	